

Address: 16 N Broadway St, Suite 43
Tacoma, WA 98403
Phone: 206-510-4163
e-mail: Ayoub@emeraldarcdesign.com

MARINERS WAY

2234 MARINERS WAY #159 OAK HARBOR, WA 98277



4 FRONT VIEW



3 REAR VIEW

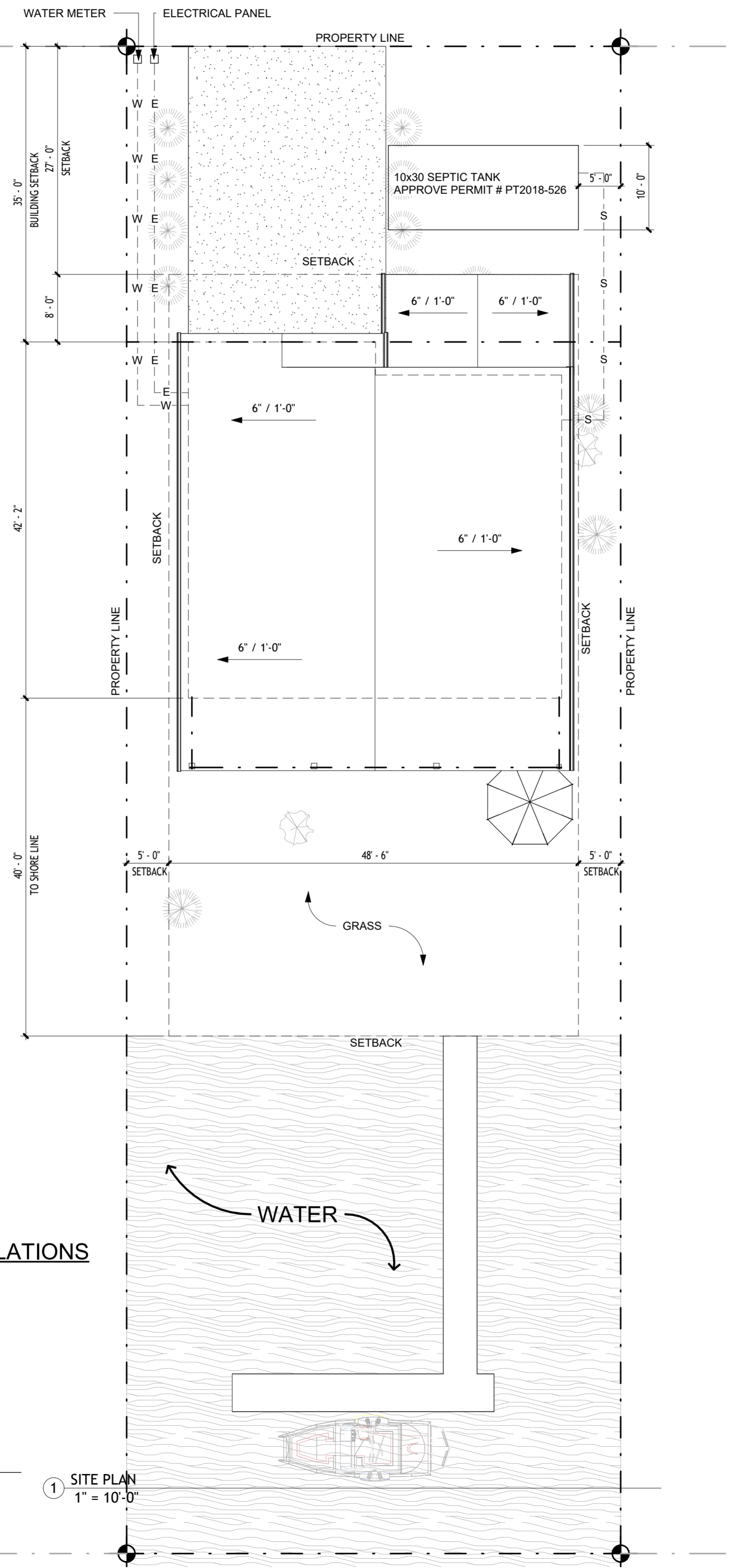

IMPERVIOUS CALCULATIONS

NEW HOUSE:	1,200 SF
ATTACHED GARAGE:	464 SF
NEW DRIVEWAY:	670 SF
NEW COVERED PATIO:	350 SF
TOTAL:	2,684 SF

LOT SIZE: 11761 SF
= 22.8%

1 SITE PLAN
1" = 10'-0"

OWNER

MILES
TEL: (253) 324-3798

CODE DATA

PROPERTY INFO

ZONE	RURAL RESIDENTIAL
LANDUSE DESIGNATION	RESIDENTIAL RAIDS
RAID NAME	MARINER'S COVE
MIN LOT SIZE	21780
RAID	YES
ZONE ABBREVIATED	RR
ZONING CODE	VIEW
PARCEL	S7485-00-00159-0
LOCAL JURISDICTION:	ISLAND COUNTY
GIS ACRES	0.2685944
WATER_SOURCE	MARINERS COVE BEACH CLUB INC (A)

PROJECT DESCRIPTION

NEW 1,200 SF RESIDENCE WITH NEW ATTACHED
464 SF GARAGE

STRUCTURAL ENGINEER

JESSE LANDERS CONSULTING ENGINEER
(360) 909-7292

INDEX

SHEET #	ARCHITECTURE	DRAWING DESCRIPTION	SHEET
A100		COVER, SITE PLAN	
A101		PROPOSED FLOOR PLAN	
A102		BUILDING ELEVATIONS	
A103		BUILDING ELEVATIONS	
A104		ROOF PLAN	
A105		BUILDING SECTIONS & DETAILS	



VACINITY MAP

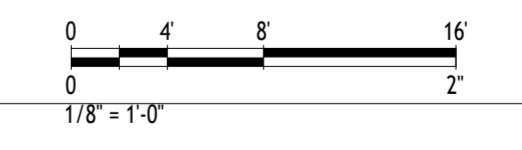
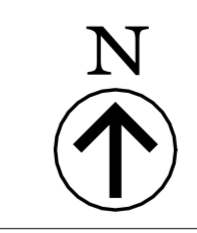

OAK HARBOR RESIDENCE

2234 Mariners Way
#159 Oak Harbor, WA
98277

SITE PLAN

PROJECT PARCEL	1
DATE	Issue Date

A100
Scale As indicated

